

Exhibition Stand Information

for

Natural Health Products NZ Innovation Expo 2024

21 November 2024, Sir Noel Robinson Conference Centre,
Due Drop Events Centre, Manukau, Auckland

SPACE

You will be supplied with:

- 1 x trestle table, 1.8m x 0.76m in a space measuring 2.8m x 1.76m which will allow you 1.0m of additional space behind you that you can use for signage.
- 2 x chairs
- 1 x black tablecloth that will go down to the floor. **If you don't require a table, tablecloth and/or chair(s) please advise.**

POWER

- There will be power available to each exhibitor.
- Please bring your own extension leads and multiboard power adapters.
- **If you don't require power, please advise.**

SET-UP

- Access to the exhibition area will be from **7:30am** on Thursday 21 November 2024.
- If you require access earlier than 7:30am, you will need to let [Sheryl](#) know by Wednesday 13 November 2024.
- Please keep in mind that all those working on your stand need to be registered.

DELIVERING EXHIBITION ITEMS TO THE VENUE

- The Due Drop Events Centre can only receive courier deliveries the day before the Innovation Expo on Wednesday 20 November 2024.
- Please contact [Sheryl](#) if you need a courier label.
- Please don't forget to note down your **Stand Number** in the Special Instructions section.
- If you are unable to send your items by courier, you will need to bring them with you on the day.
- There are two entrances to the exhibitor space. Either via the main entrance or the doors directly into the exhibition space. These entrances have blue circles around them.

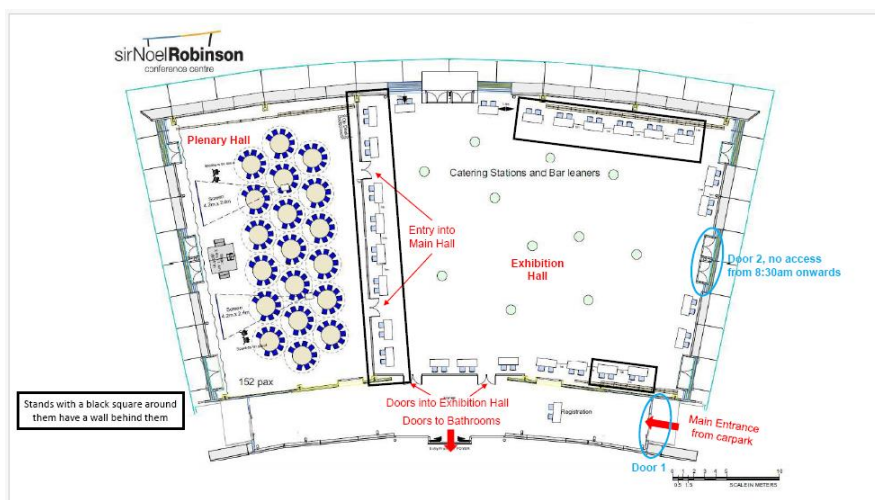

PACK DOWN

- Needs to be completed after the IMCD networking event which finishes.
- All items must be packed up and the area cleared by 8:00pm.
- **The owner/exhibitor must take all their items with them. Nothing can be left at the Due Drop Events Centre.** If you have any concerns, please contact [Sheryl](#) before the Innovation Expo.